



22 BRADFIELD AVENUE

Hadleigh | Suffolk



Chapman Sticks

22 BRADFIELD AVENUE HADLEIGH, SUFFOLK IP7 5EX

A THREE BEDROOM SEMI-DETACHED HOUSE CLOSE TO THE TOWN
CENTRE WITH GARDEN AND GARAGE

Ipswich – 9 miles
Manningtree – 10 miles
Colchester – 15 miles

-
- Entrance hall • Sitting room • Dining room • Kitchen • Cloakroom •
 - Three bedrooms • Family bathroom • Garden •
 - Off-road parking • Garage • Outbuilding / workshop •





Property

NO ONWARD CHAIN – 22 Bradfield Avenue is a three-bedroom semi-detached home believed to have been built circa 1947.

The ground floor accommodation is set around an entrance hall and comprises two reception rooms with the sitting room benefitting from a log burner with tiled hearth and attractive carved wooden surround, a cloakroom and a kitchen which offers various base and eye level units and includes an integrated 5 ring gas hob / electric oven.

On the first floor, a landing provides access to three good sized bedrooms and a family bathroom. Internally, the house does require modernisation and offers potential to extend subject to the correct planning permission.

Outside to the front lies an area of lawn enclosed by a natural hedge row, with a gate leading firstly to a courtyard with decking which extends out to the main garden to the rear, which is of a generous size and is divided into two parts by a double garage - this was a later addition in 2009. The property benefits from a further outbuilding / workshop and a garden shed.



Location

Hadleigh is a very popular historic market town situated about 9 miles west from Ipswich. The bustling town centre offers a wide range of local amenities including restaurants, pubs, sports facilities and a wide selection of shops, as well as both Junior and Senior schools.

Services

We understand all main services are connected.

Local Authority and Council Tax Band

Babergh with Mid Suffolk District Council Band B (2026)

EPC Rating

Current E (54). Potential C (79).



22 Bradfield Avenue, Hadleigh, IP7 5EX

Approximate Floor Area
Main House - 946 sq. ft / 87.91 sq. m
Garage - 344 sq. ft / 31.94 sq. m
Outbuilding - 47 sq. ft / 4.40 sq. m



Chapman Stickels

The Corn Exchange,
Market Place,
Hadleigh,
Suffolk,
IP7 5DN

info@chapmanstickels.co.uk
www.chapmanstickels.co.uk

01473 372 372

All enquiries:

Benedict Stickels
ben@chapmanstickels.co.uk

Cleo Shiel
cleo@chapmanstickels.co.uk



Scan the QR code to visit our website

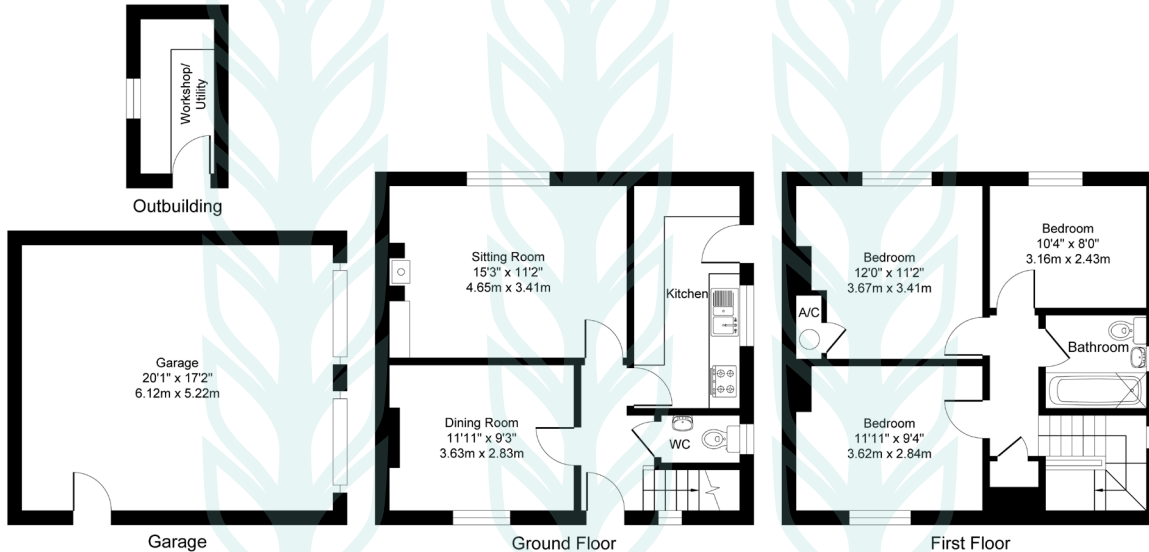

Illustration for identification purposes only, measurements approximate, not to scale. Copyright

rightmove

PrimeLocation.com

onTheMarket.com

Zoopla



IMPORTANT NOTICE
Chapman Stickels states these particulars are for general information only and do not constitute an offer or contract or part thereof. All descriptions, photographs and plans are for guidance only and should not be relied upon as statements or representations of fact. All measurements are approximate where stated. Any prospective purchaser must satisfy themselves of the accuracy of the information within these particulars by inspection or otherwise. Chapman Stickels does not have any authority to give any representations or warranties whatsoever in relation to this property (including but not limited to planning/building restrictions), nor can it enter into any contract on behalf of the client. We do not accept responsibility for any expenses incurred by prospective purchasers in inspecting properties which have been sold, let or withdrawn. If there is anything of particular importance to you, please contact us where we will endeavour to have any information or queries checked.